

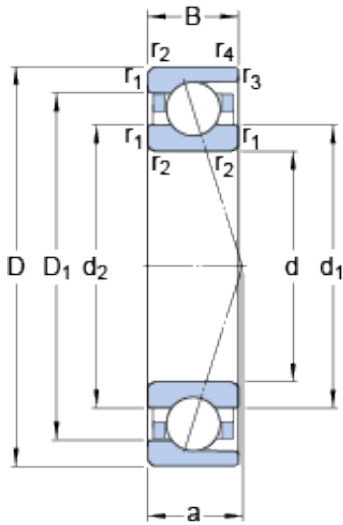

SKF DRIVESHAFT CORP



71819 CD/HCP4 Bearing 2D drawings and 3D CAD models

95 mm x 120 mm x 13 mm skf 71819 CD/HCP4 Super-precision Angular contact ball bearings

Bearing No. 71819 CD/HCP4

Size	120x95x13 mm
Bore Diameter	120 mm
Outer Diameter	95 mm
Width	13 mm
d	95 mm
D	120 mm
B	13 mm
d ₁	103.2 mm
d ₂	103.2 mm
D ₁	112.1 mm
r _{1,2} - min.	1 mm
r _{3,4} - min.	0.3 mm
a	20.9 mm
d _a - min.	99.6 mm
d _b - min.	99.6 mm
D _a - max.	115.4 mm
D _b - max.	118 mm
r _a - max.	1 mm
r _b - max.	0.3 mm
d _n	104.1 mm
Basic dynamic load rating - C	22.1 kN
Basic static load rating - C ₀	27.5 kN
Fatigue load limit - P _u	1.1 kN
Limiting speed for grease	12000 r/min



SKF DRIVESHAFT CORP

Lubrication	
Limiting speed for oil lubrication	19000 mm/min
Ball - D_w	7.144 mm
Ball - z	32
G_{ref}	3.1 cm ³
Calculation factor - f_0	17.3
Preload class A - G_A	117 N
Preload class B - G_B	355 N
Preload class C - G_C	710 N
Calculation factor - f	1.36
Calculation factor - f	1
Calculation factor - f_{2A}	1
Calculation factor - f_{2B}	1.1
Calculation factor - f_{2C}	1.18
Calculation factor - f_{HC}	1.02
Preload class A	94 N/micron
Preload class B	164 N/micron
Preload class C	242 N/micron
d_1	103.2 mm
d_2	103.2 mm
D_1	112.1 mm
$r_{1,2}$ min.	1 mm
$r_{3,4}$ min.	0.3 mm
d_a min.	99.6 mm
d_b min.	99.6 mm
D_a max.	115.4 mm
D_b max.	118 mm
r_a max.	1 mm
r_b max.	0.3 mm
d_n	104.1 mm



SKF DRIVESHAFT CORP

Basic dynamic load rating C	22.1 kN
Basic static load rating C_0	27.5 kN
Fatigue load limit P_u	1.12 kN
Attainable speed for grease lubrication	12000 r/min
Attainable speed for oil-air lubrication	19000 r/min
Ball diameter D_w	7.144 mm
Number of balls z	32
Reference grease quantity G_{ref}	3.1 cm ³
Preload class A G_A	117 N
Static axial stiffness, preload class A	94 N/ μ m
Preload class B G_B	355 N
Static axial stiffness, preload class B	164 N/ μ m
Preload class C G_C	710 N
Static axial stiffness, preload class C	242 N/ μ m
Calculation factor f	1.36
Calculation factor f_1	1
Calculation factor f_{2A}	1
Calculation factor f_{2B}	1.1
Calculation factor f_{2C}	1.18
Calculation factor f_{HC}	1.02
Calculation factor f_0	17.3
Mass bearing	0.26 kg